

EXTERNAL PROVIDER ROLE - PROVIDER'S SIGNATURES

A provider may be created and assigned the External Provider Role to log into MotionMD and sign patient agreements. The provider has the option to individually or batch sign patient agreements.

Obtaining the Provider's signature with the batch sign function:

The Provider will select 'Sign All'.

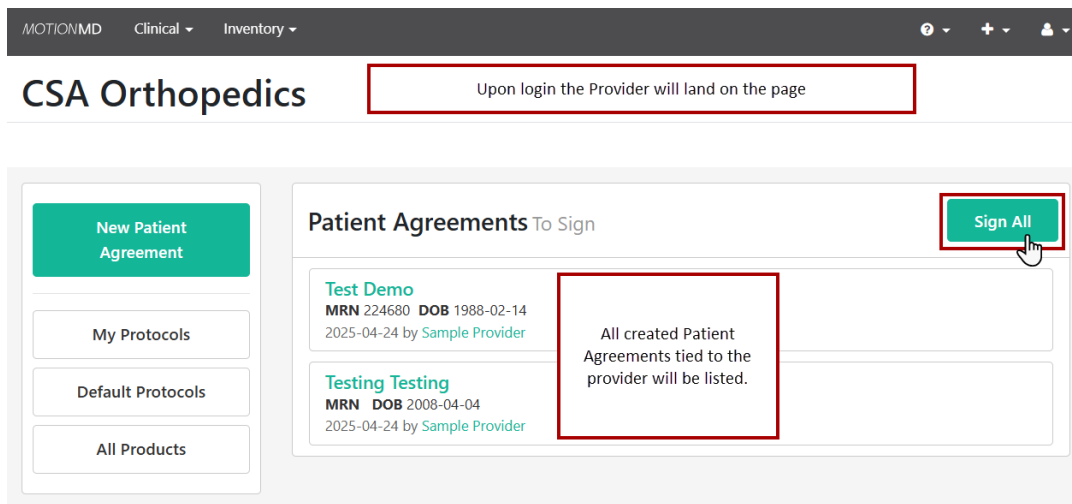

MOTIONMD Clinical Inventory

CSA Orthopedics

Upon login the Provider will land on the page

New Patient Agreement

My Protocols

Default Protocols

All Products

Patient Agreements To Sign

Sign All

Test Demo
MRN 224680 DOB 1988-02-14
2025-04-24 by Sample Provider

Testing Testing
MRN DOB 2008-04-04
2025-04-24 by Sample Provider

All created Patient Agreements tied to the provider will be listed.

The Provider will review and select the Patient Agreements to batch sign.

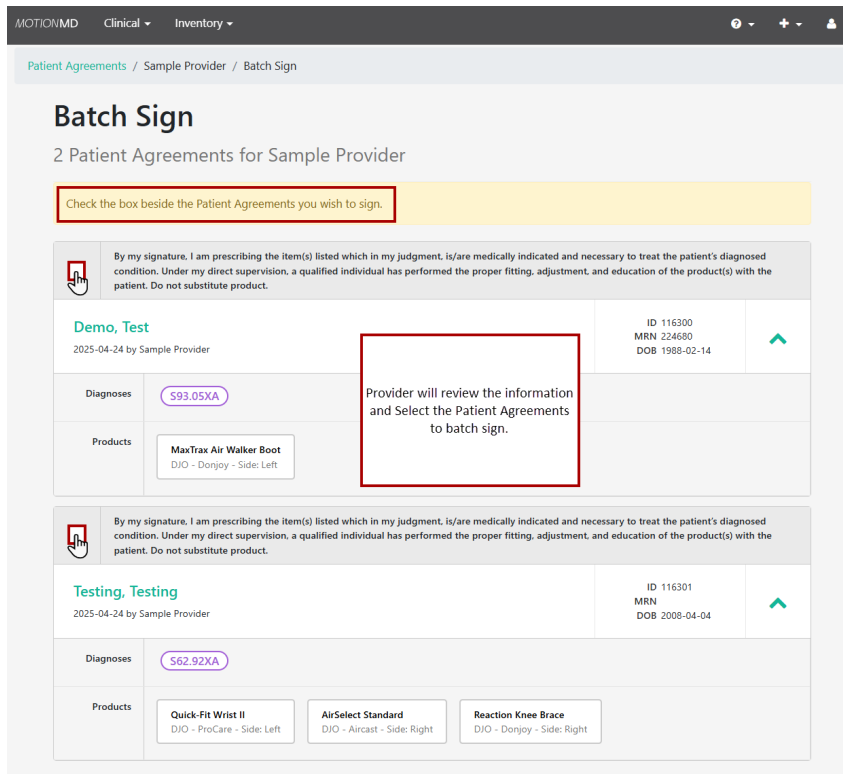

MOTIONMD Clinical Inventory

Patient Agreements / Sample Provider / Batch Sign

Batch Sign

2 Patient Agreements for Sample Provider

Check the box beside the Patient Agreements you wish to sign.

By my signature, I am prescribing the item(s) listed which in my judgment, is/are medically indicated and necessary to treat the patient's diagnosed condition. Under my direct supervision, a qualified individual has performed the proper fitting, adjustment, and education of the product(s) with the patient. Do not substitute product.

☒ Demo, Test
2025-04-24 by Sample Provider

ID 116300
MRN 224680
DOB 1988-02-14

Diagnoses S93.05XA

Products MaxTrax Air Walker Boot
DJO - Donjoy - Side: Left

Provider will review the information and Select the Patient Agreements to batch sign.

By my signature, I am prescribing the item(s) listed which in my judgment, is/are medically indicated and necessary to treat the patient's diagnosed condition. Under my direct supervision, a qualified individual has performed the proper fitting, adjustment, and education of the product(s) with the patient. Do not substitute product.

☒ Testing, Testing
2025-04-24 by Sample Provider

ID 116301
MRN
DOB 2008-04-04

Diagnoses S62.92XA

Products Quick-Fit Wrist II
DJO - ProCare - Side: Left

AirSelect Standard
DJO - Aircast - Side: Right

Reaction Knee Brace
DJO - Donjoy - Side: Right

EXTERNAL PROVIDER ROLE - PROVIDER'S SIGNATURES

Once the Patient Agreements have been selected, the provider will sign in the Provider Signature box. Then select the signature authorization box. To complete batch provider signature, select 'Sign Selected patient Agreements'.

<input checked="" type="checkbox"/>	By my signature, I am prescribing the item(s) listed which in my judgment, is/are medically indicated and necessary to treat the patient's diagnosed condition. Under my direct supervision, a qualified individual has performed the proper fitting, adjustment, and education of the product(s) with the patient. Do not substitute product.
Demo, Test 2025-04-24 by Sample Provider	ID 116300 MRN 224680 DOB 1988-02-14

<input checked="" type="checkbox"/>	By my signature, I am prescribing the item(s) listed which in my judgment, is/are medically indicated and necessary to treat the patient's diagnosed condition. Under my direct supervision, a qualified individual has performed the proper fitting, adjustment, and education of the product(s) with the patient. Do not substitute product.
Testing, Testing 2025-04-24 by Sample Provider	ID 116301 MRN DOB 2008-04-04

2 patient agreements have been selected for batch sign.

[Provider Signature](#)
[Reset Signature](#)

Provider Signature

☒ By clicking this box, I hereby authorize my above signature to be electronically affixed as my official signature authorizing all of the above referenced orders.

Sign Selected Patient Agreements

Provider selects box to authorize signature.

EXTERNAL PROVIDER ROLE - PROVIDER'S SIGNATURES

Obtaining the Provider Signature on an individual Patient Agreement

The provider will select the Patient Agreement to sign.

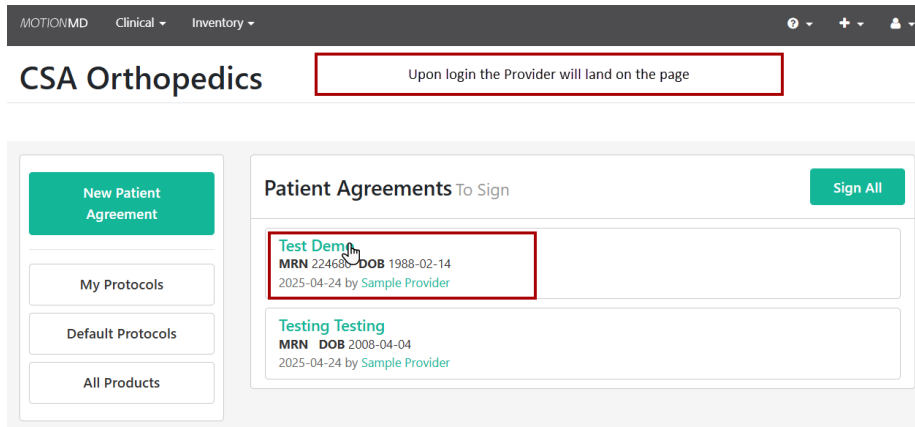

The provider will review the Patient Agreement and navigate to the Provider Signature section, by scrolling or utilizing the toolbar. The provider will select 'Add Provider Signature', then 'Provider Signature' to open the signature box.

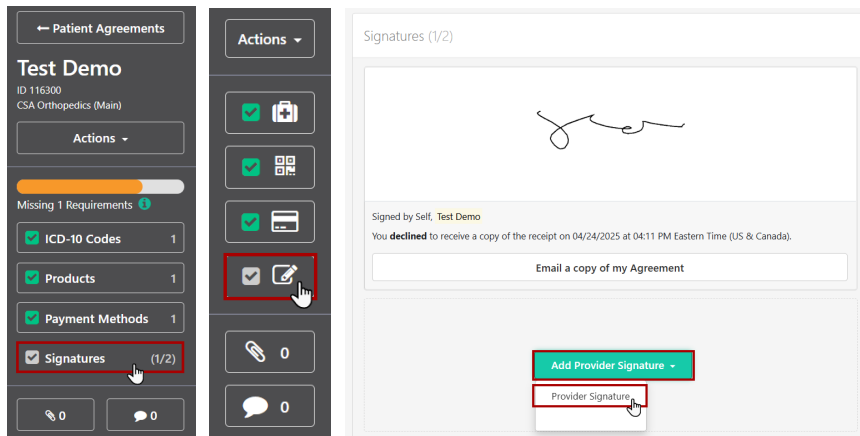

The provider will review the Provider Attestation and sign the Patient Agreement.

